

Expressions of interest Stukeleys Community Allotment Tender

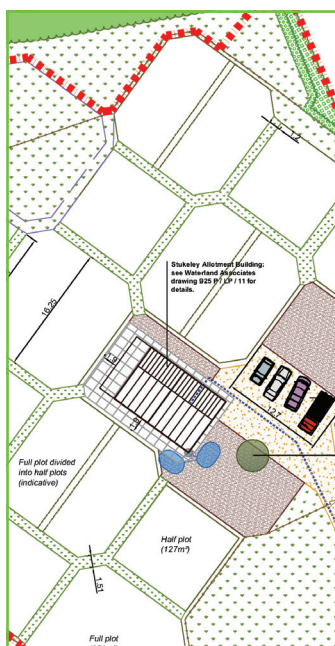

Urban&Civic in conjunction with the Stukeleys Parish Council will shortly be going out to tender for a contractor to support the delivery of a community allotment and woodland scheme in the village of Great Stukeley, to the north west of Huntingdon in Cambridgeshire.

The work will be scheduled to take place in June 2013, and a full tender pack is in production. We are ideally looking for one contractor to deliver the scope of works listed below over a 2–3 week period.

We are keen to hear from local companies who would be interested in being included in the tender process and so are asking for **expressions of interest**. The list below is not a full or detailed one, but is provided to show the range of tasks involved.

To find out **more information** about the project please contact Rebecca Britton on 01480 413141 / 07739 339 889 or e-mail rbritton@urbanandcivic.com

To **register your interest** please e-mail your contact details and a short summary of your company to Tom Baker at tb@urbanandcivic.com

SCOPE OF WORKS

ALLOTMENT FACILITIES

- Edging to plots
- Grass/stone/mulch paths between plots
- Source, supply and install circular tree seat

HARD LANDSCAPE

- Access drive and edging
- Supply and lay 100mm organic bark mulch over permeable geotextile to pedestrian areas
- Edging to pedestrian surfacing
- Cleft oak post and rail fencing
- Rabbit fencing
- Lockable timber gate
- Possible woodland path

ENABLING AND CIVILS

- Clearance of existing vegetation to enable construction of new entrance
- Fill existing ditch to create crossing including pipe culvert and headwalls
- Remediation – sub-surface and top soil
- Some water supply work linking in with specialist contractor

SOFT LANDSCAPE

- Prepare species rich grassland area
- Supply and sow species rich grassland:
- Establishment and maintenance of species rich grassland

